

A1

DO NOT SCALE

File: CP1770-BLP-02-ZZ-M2-MA-0200-00 Proposed Berth 52.dwg
Date: Jul 04, 2019 - 3:49pm
Plotted by: TJOConnell

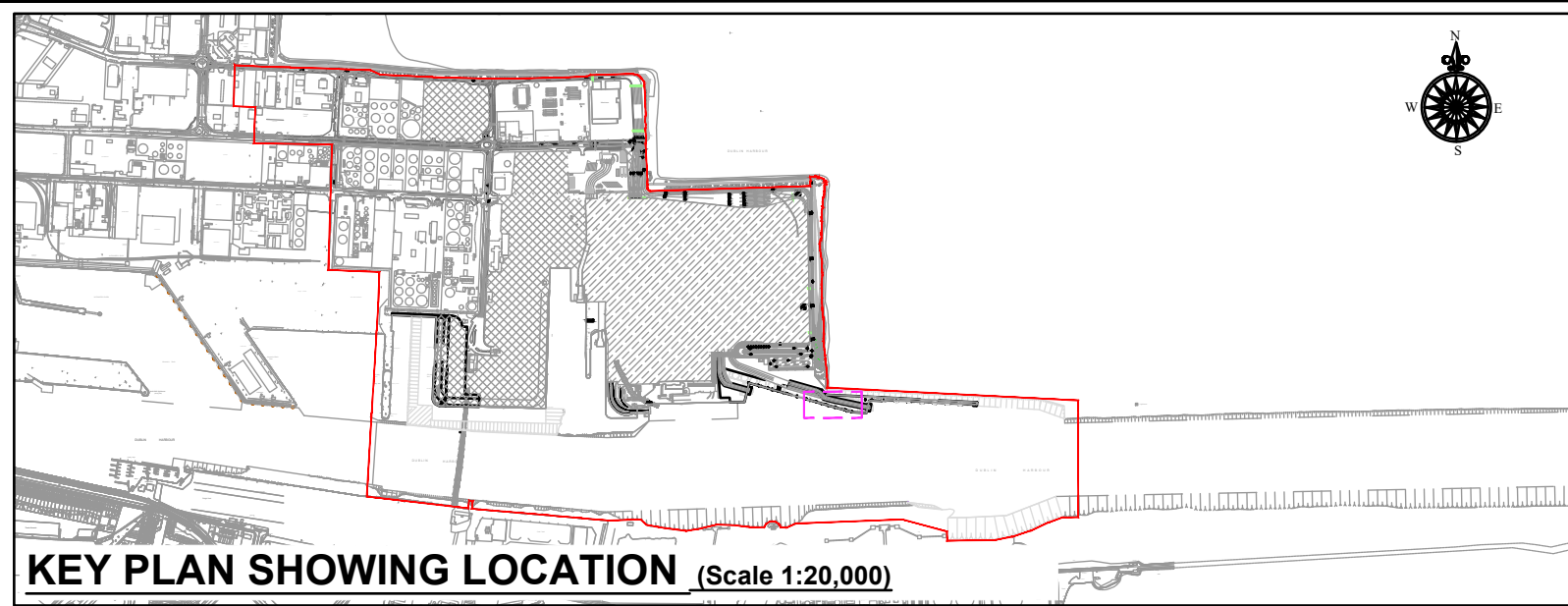

ELEVATION OF BERTH 52 (Scale 1:1000)

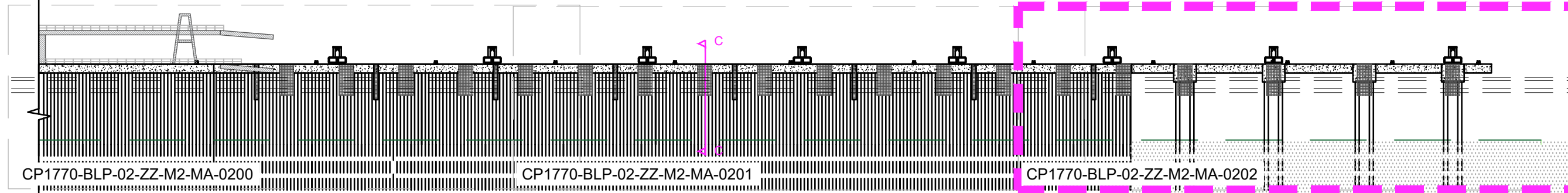

ELEVATION OF BERTH 52 (WITH TYPICAL VESSEL) (Scale 1:1000)

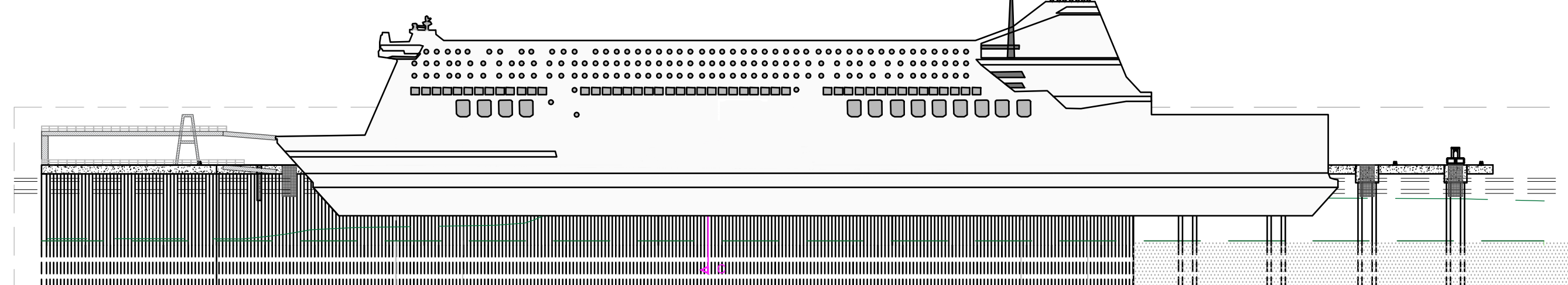

GENERAL NOTES

1. ALL DIMENSIONS ARE IN MILLIMETRES UNLESS NOTED OTHERWISE.
 2. ONLY WRITTEN DIMENSIONS SHALL BE USED. NO DIMENSIONS SHALL BE SCALED FROM THE DRAWINGS.
 3. ALL LEVELS ARE IN METRES AND ARE TO ORDNANCE DATUM MALIN UNLESS NOTED OTHERWISE.
 4. ALL COORDINATES ARE IN METRES AND ARE TO IRISH TRANSVERSE MERCATOR.
 5. DRAWINGS ARE TO BE READ IN CONJUNCTION WITH THE SPECIFICATION.
 6. ALL DRAWINGS ARE THE PROPERTY OF ATKINS BYRNELOOBY.
 7. [xx.xx m CD] REFER TO LEVELS AT CHART DATUM (DUBLIN PORT).
 8. ORDNANCE DATUM MALIN [O.D.M.]
- CHART DATUM [C.D.] (DUBLIN PORT) 2.51m
9. KEY PLAN LOCATION. [Dashed box]
 10. OS MAP SHEET NO:
3198-18, 3198-19, 3198-20, 3198-23, 3198-24, 3198-25, 3199-16, 3199-17, 3199-18, 3199-21, 3199-23, 3199-24, 3264-2, 3264-3, 3264-4, 3264-5, 3264-8, 3264-9, 3264-10, 3264-13, 3264-14, 3264-15, 3265-1, 3265-6, 3265-7, 3265-8, 3265-9, 3265-11, 3265-12.

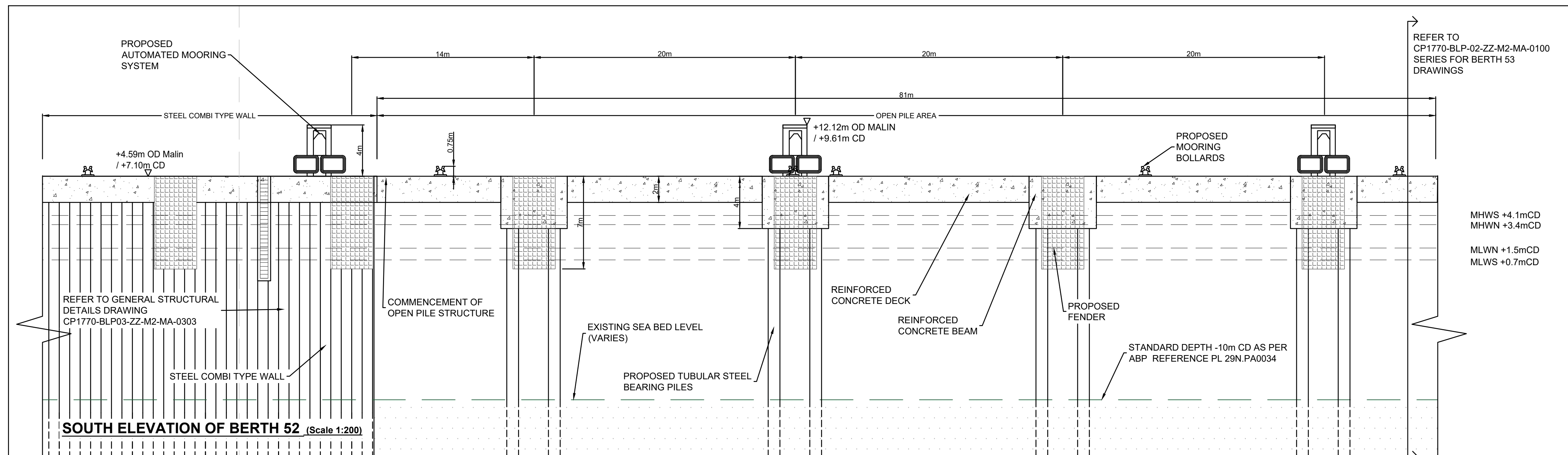

Ordnance Survey Ireland Licence No. EN 0061919
© Ordnance Survey Ireland/Government of Ireland

- APPLICATION BOUNDARY
- PROPOSED SCOUR PROTECTION MATTRESS ON SEA BED
- DREDGED SIDE SLOPES
- PROPOSED DREDGED AREA
- EXISTING BED LEVEL
- PROPOSED CONCRETE DECK
- PROPOSED 30m HIGHMAST LIGHTING
- PROPOSED 15m HIGHMAST LIGHTING
- PROPOSED STREET LIGHTING
- EXISTING 30m HIGHMAST LIGHTING
- EXISTING LIGHTING
- EXISTING STREET LIGHTING

Rev	Description	By	Date	Chk'd	Auth
00	ISSUED FOR PLANNING	TJOC	07.19	SMC	AC

ATKINS
Member of the SNC-Lavalin Group

BYRNELOOBY
WS Atkins Ireland Ltd. & ByrneLooby Partners Ltd.
Atkins House,
150 Airside Business Park,
Swords, Co. Dublin

Client
**COMHLACHT CHALAFOR
ÁTHA CLIATH
DUBLIN PORT COMPANY**

Project
MP2

Purpose PLANNING					
Title PROPOSED BERTH 52 SHEET 3 OF 3					
Original Scale AS SHOWN @A1	Design/Drawn TJOC	Checked SMC	Authorised AC	Date 28.09.18	Date 28.09.18
Status P	Drawing Number CP1770-BLP-02-ZZ-M2-MA-0202	Rev 00			